



**GLOBAL TELECOM
ENGINEERING**

WE ENGINEER CONNECTIVITY

Quick Start Guide

TITAN 5100 5G Window CPE

Simple setup.
Powerful connectivity.



Watch a quick setup video

<https://glob-tel.com/quick-start-guides/titan-5100-quick-start-guide>



LET'S GET STARTED

What's in The Box

TITAN 5100 Device	PoE and Power Cord	Ethernet Cable	Window Mount Suction Cups	
Window/Wall Mount Secure 3M Adhesive Mounting Tape	Wall Mount Bracket (incl. 4 screws)	Pole Mount Bracket (incl. 4 screws and pole clamp)	Tamper-Proof Cover	Waterproof Seal Tape

BASIC SETUP

Your device is ready to go out-of-box once it's powered up and placed in the best spot at your location. Unscrew SIM card port and insert SIM. Press SIM in until you feel the spring catch.

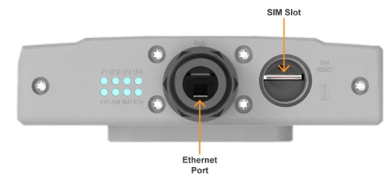

1 Select a window to mount your device

For best performance select an open location on an upper floor/high off the floor with no interference from other electrical devices like microwaves.

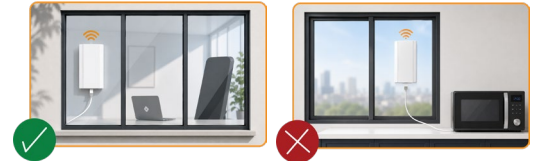

2 Set up TITAN 5100 device and PoE

Remove the plug located at the bottom of the TITAN 5100 and insert one end of the white Ethernet cable into the device. Insert the opposite end of the Ethernet cable into the PoE ETH port. Attach power cord into the PoE and plug into a wall socket.



3 Find the Best Signal location using Mobile Guided Set Up in various window locations.

1. Screw-in suction cups to the back of the device and place the device on the inside of your window to test signal strength. Press device firmly to ensure it's securely attached to the window.
2. Check signal strength and using the Mobile Guided set-up instructions.
3. To test another location, carefully remove device from window. It may help to pull the corners of each suction cup one at a time.



4 Once you've found your best performing location choose a Mounting Set Up

1. For Window Mount: Clean window with alcohol wipe and let dry. Remove suction cups and place them back in box.
2. Attach wall mount bracket to the back of the TITAN 5100 and slide it up to lock into place. Attach the Tamper Proof Cover to lock the device to the bracket.
3. Remove 1 side of the Mounting Tape and apply to the flat back of the wall bracket.
4. Remove the back side of the Mounting Tape and press it firmly to the clean Window.
5. See last page for additional ways to mount your device: Indoor/Outdoor on Window or Wall and Outdoor Pole mount.

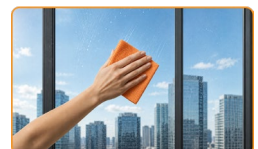



MOBILE GUIDED SETUP AND DEVICE MANAGEMENT

To ensure optimal coverage for your TITAN 5100, follow the Step-by-Step Guide below to find the best placement for your device. You must have your TITAN 5100 powered up and active when scanning the QR code for **Mobile Guided SETUP Guide**.

Important Note:

The Wi-Fi ID name (SSID) and Password are printed on the PoE sticker. Once powered up, the device will automatically connect to the network. You can now connect to the TITAN 5100 WIFI using SSID and Password. Wi-Fi management, including User ID and Password change can be managed through the Mobile application.

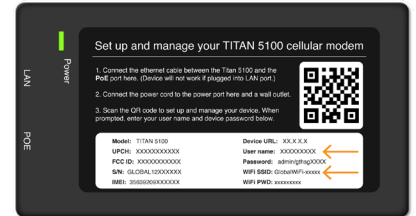

1 Use mobile device to scan QR code once device is activated.
QR code is located on the top of the PoE adapter. By scanning the QR code, your mobile device will automatically connect to the WIFI network for device management. The mobile device browser will automatically access the management page on your connected device.

2 Enter User name and password
Locate your account application User name and Password located on the PoE label.



3 Follow device setup instructions
Select device setup and follow instructions to test performance and place the device in the best signal location. Your Wi-Fi SSID User name and Password are located on the PoE label.

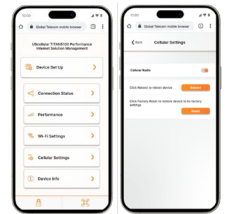

4 Ongoing device management
Rescan QR code whenever you need to come back to manage your device, test performance, and conduct basic troubleshooting.

No access to a mobile device? You can also connect your TITAN 5100 to your PC if you have your own Ethernet cable: connect your cable from the PoE adapter **LAN** port to the laptop Ethernet port. **When connected**, open a web browser. Type: <http://192.168.0.1> in the address bar. In the pop-up window, enter the device Username and Password (case sensitive) from the label on the PoE adapter to log in.

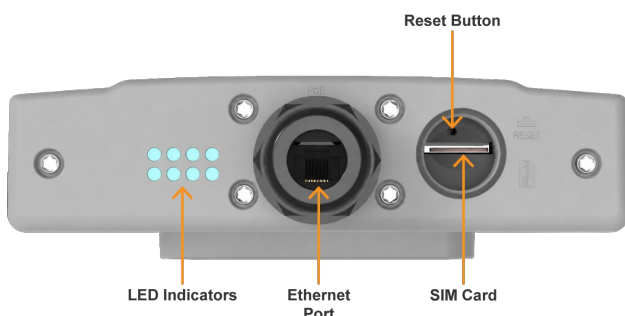



Mounting Options

Suction Cup Window Mount



Window Mount

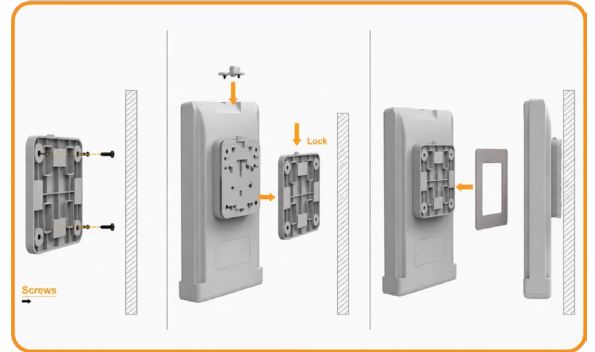

Bracket Wall Mount

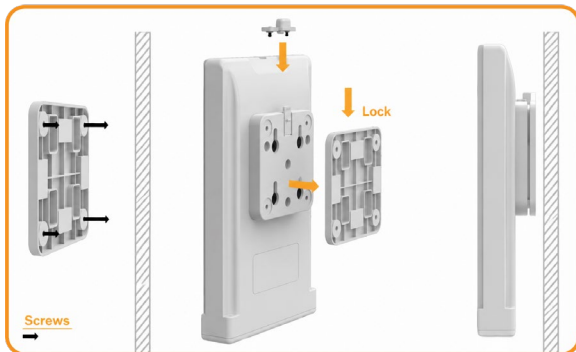

Outdoor Pole Clamp Mount

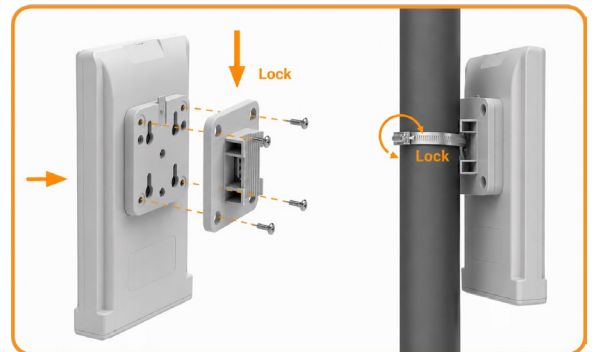

Troubleshooting

For Troubleshooting help go to <https://glob-tel.com/titan-5100> to download the TITAN 5100 User Guide.

FCC Radiation Exposure Statement:

This equipment complies with FCC radiation exposure limits set forth for an uncontrolled environment. This equipment should be installed and operated with minimum distance 20cm between the radiator & your body.

FCC Warning

This device complies with Part 15 of the FCC Rules. Operation is subject to the following two conditions: (1) This device may not cause harmful interference, and (2) this device must accept any interference received, including interference that may cause undesired operation.

NOTE 1: This equipment has been tested and found to comply with the limits for a Class B digital device, pursuant to part 15 of the FCC Rules. These limits are designed to provide reasonable protection against harmful interference in a residential installation. This equipment generates uses and can radiate radio frequency energy and, if not installed and used in accordance with the instructions, may cause harmful interference to radio communications. However, there is no guarantee that interference will not occur in a particular installation. If this equipment does cause harmful interference to radio or television reception, which can be determined by turning the equipment off and on, the user is encouraged to try to correct the interference by one or more of the following measures:

- Reorient or relocate the receiving antenna.
- Increase the separation between the equipment and receiver.
- Connect the equipment into an outlet on a circuit different from that to which the receiver is connected.
- Consult the dealer or an experienced radio/TV technician for help.

NOTE 2: Any changes or modifications to this unit not expressly approved by the party responsible for compliance could void the user's authority to operate the equipment.